



ALLOY & STAINLESS FASTENERS



Bolts • Nuts • Studs Sockets

Stainless Steels • Nickel Alloys • Copper Alloys • Aluminum Alloys
Duplex • Super Duplex • Alloy Steels • Specialty Steels • Titanium

Over 25 Choices of Coatings and Platings

We Service All Quantities
Emergencies
Maintenance
Projects

WESTERN USA / CANADA
13780-C SW Galbreath Dr.
Sherwood, OR 97140 USA
503-885-2464
Western@GoASF.com

CENTRAL USA
11800-B Charles Road
Houston, TX 77041 USA
713-466-3031
Central@GoASF.com

EASTERN USA / CANADA
521 Schoolhouse Road
Telford, PA 18969 USA
215-721-3900
Eastern@GoASF.com

GLOBAL
11800-B Charles Road
Houston, TX 77041 USA
713-929-0480
Global@GoASF.com

ALLOY & STAINLESS FASTENERS

INVENTORY



Bulk Warehouse Fastener Inventory



Bar Stock Inventory



Bulk Shipment Inventory



Local Distribution Inventory

QUALITY ASSURANCE



Positive Material Identification



Internal & External Thread Inspection

Quick Delivery



ALLOY & STAINLESS FASTENERS



STOCK OVERVIEW

NUTS

HEAVY HEX

ASTM A194

GRADE

2H

2H ZINC & CLEAR

2H ZINC & YELLOW

2H METRIC (H=D)

2HM

3

6

6F

7

7L

7M

16

8

8 METRIC (H=D)

8A

8 STRAIN HARDENED

8C

8F

8M

8M METRIC (H=D)

8MA

8M STRAIN HARDENED

8T

HEAVY HEX

ASTM A453

GRADE

660B NR

660D NR

STAINLESS STEELS

GRADE

304

304 STRAIN HARDENED

310

316

316 ELC

316 STRAIN HARDENED

321

410

416

NON-FERROUS

GRADE

ALLOY 20

ALLOY 400

DUPLEX 2205

HASTELLOY C-276

FINISHED HEX

ASTM A194

GRADE

2H

8

STAINLESS STEELS

GRADE

18/8

304 ELC

304 STRAIN HARDENED

309

310

316

316 ELC

316 STRAIN HARDENED

317 ELC

410

ALLOY 20

NON-FERROUS

GRADE

ALLOY 400

DUPLEX 2205

HASTELLOY C-276

SILICON BRONZE





ALLOY & STAINLESS FASTENERS



STOCK OVERVIEW

BOLTS

ASTM A193 BOLTS

GRADE	HEAD TYPE	GRADE	HEAD TYPE
B5	HEAVY HEX	B8 Class 1	HEAVY HEX
B6	HEAVY HEX		FINISHED HEX
B7	HEAVY HEX	B8 Class 2	HEAVY HEX
	FINISHED HEX		FINISHED HEX
	12 POINT FLANGE	B8M Class 1	HEAVY HEX
B7M	HEAVY HEX		FINISHED HEX
	FINISHED HEX	B8M Class 2	HEAVY HEX
B16	HEAVY HEX		FINISHED HEX
	FINISHED HEX	B8C	HEAVY HEX
		B8T	HEAVY HEX

ASTM A320 BOLTS

GRADE	HEAD TYPE
L7	HEAVY HEX
B8 Class 1	HEAVY HEX
B8 Class 2	HEAVY HEX
B8M Class 1	HEAVY HEX
B8M Class 2	HEAVY HEX

STAINLESS HEX BOLTS

GRADE	HEAD TYPE	GRADE	HEAD TYPE
304	FINISHED HEX	317 ELC	FINISHED HEX
304 ELC	FINISHED HEX	321	FINISHED HEX
309	FINISHED HEX	347	FINISHED HEX
310	FINISHED HEX	410	FINISHED HEX
316	FINISHED HEX	ALLOY 20	FINISHED HEX
316 ELC	FINISHED HEX	ALLOY 400	FINISHED HEX
		DUPLEX 2205	FINISHED HEX

NON-FERROUS & HIGH-NICKEL ALLOY BOLTS

GRADE	HEAD TYPE	GRADE	HEAD TYPE
17-4 PH	FINISHED HEX	K-MONEL	FINISHED HEX
HASTELLOY	FINISHED HEX	MONEL 400	FINISHED HEX
INCOLOY	FINISHED HEX	NICKEL 200	FINISHED HEX
INCONEL	FINISHED HEX	NITRONIC 60	FINISHED HEX

Quick Delivery



ALLOY & STAINLESS FASTENERS



STOCK OVERVIEW

RODS

CONTINUOUS THREADED ROD

ASTM A193

GRADE	DIAMETER
B7	1/4" TO 4"
B7 METRIC	M8 TO M36
B16	5/16" TO 3 1/2"
B8	1/2" TO 2 1/2"
B8M	1/2" TO 2 1/2"

ASTM A354

GRADE	DIAMETER
BD	3/8" TO 2"

AISI

GRADE	DIAMETER
304	3/8" TO 3/4"
304 / A2	M6 TO M30
316	3/8" TO 3/4"
316 / A4	M12 TO M30



ASTM A320

GRADE	DIAMETER
L7	1/4" TO 2 1/2"
B8	1/2" TO 2 1/2"
B8M	1/2" TO 2 1/2"

**Threaded Rod
Manufacturing
for Your Specials**



STOCK OVERVIEW

WASHERS

MATERIAL	FLAT	LOCK
18/8	1/4" TO 2"	1/4" TO 1 3/8"
310	1/4" TO 1 1/4"	
316	#6 TO 2"	#8 TO 1 1/2"
316 METRIC	M8 TO M14	M6 TO M20
316 ELC	1/4" TO 1 1/2"	
317 ELC	3/8" TO 1/2"	
321	1/4" TO 1 1/2"	
410	1/4" TO 1"	1/2" TO 3/4"
ALLOY 20	1/4" TO 1"	3/8"
ALLOY 400	1/4" TO 1"	
HASTELLOY C-276	3/8" TO 1"	3/8" TO 3/4"
DUPLEX 2205	3/8" TO 1 1/4"	
K-MONEL		1/4" TO 1"
F436	1/2" TO 2 1/2"	

BOLT SIZE	FLAT WASHER DIMENSIONS STAINLESS STEEL		
	O.D.	I.D.	THK.
1/4"	5/8"	9/32"	.050"
5/16"	3/4"	11/32"	.050"
3/8"	7/8"	13/32"	.063"
7/16"	1 1/8"	15/32"	.063"
1/2"	1 1/4"	17/32"	.078"
9/16"	1 3/8"	19/32"	.078"
5/8"	1 1/2"	11/16"	.078"
3/4"	1 3/4"	13/16"	.109"
7/8"	2"	15/16"	.109"
1"	2 1/4"	1 1/16"	.125"
1 1/8"	2 1/2"	1 3/16"	.125"
1 1/4"	2 3/4"	1 5/16"	.125"
1 3/8"	3"	1 7/16"	.125"
1 1/2"	3"	1 9/16"	.140"
1 3/4"	3 1/2"	1 7/8"	.160"
2"	4"	2 1/8"	.160"

STAINLESS STEEL FLAT WASHERS ARE GRADE MARKED EXCEPT FOR THE 18/8.

24 - 7 Service



ALLOY & STAINLESS FASTENERS



STOCK OVERVIEW

SOCKETS

ASTM A193 SOCKET CAP SCREWS

GRADE	HEAD TYPE	GRADE	HEAD TYPE
B7	SOCKET CAP	B8 Class 1	SOCKET CAP
B7M	SOCKET CAP	B8 Class 2	SOCKET CAP
B16	SOCKET CAP	B8M Class 1	SOCKET CAP
		B8M Class 2	SOCKET CAP

ASTM A320 SOCKET CAP SCREWS

GRADE	HEAD TYPE
L7	SOCKET CAP



STOCK MATERIALS

STUDS

CONTINUOUS THREADED STUDS AND STUD BOLTS

Stud Bolt assemblies with 2 Hex Nuts available upon request

ASTM A193

GRADE
 B5
 B6
 B7
 B7M
 B7 METRIC
 B8 CLASS 1
 B8 CLASS 2
 B8 METRIC
 B8C
 B8M CLASS 1
 B8M CLASS 2
 B8M METRIC
 B8S
 B8T
 B16

ASTM A320

GRADE
 B8 CLASS 1
 B8 CLASS 2
 B8M CLASS 1
 B8M CLASS 2
 L7

ASTM A354

GRADE
 BD

ASTM A453

GRADE
 660B
 660D

STAINLESS & NON-FERROUS

GRADE
 18/8
 18/8 METRIC
 304
 304 ELC
 304 STRAIN HARDENED
 309
 310
 316
 316 ELC
 316 STRAIN HARDENED
 317 ELC
 321
 330
 347
 410
 501
 ALLOY 20
 ALLOY 400
 BRASS
 DUPLEX 2205
 HASTELLOY C-276
 NITRONIC 60
 SILICON BRONZE



Quick Delivery

ALLOY & STAINLESS FASTENERS

MANUFACTURING

Over 300 Production Machines



Production Bandsaw Metal Cutting



Precision Tolerance Cutting



CNC Forging



Bar Grinding / Threading



CNC Machining



Fastener Production

24 - 7 Service



ALLOY & STAINLESS FASTENERS

MANUFACTURING

STUDS

ASF STANDARD PRODUCT TYPES

**Full Thread
Blank (Unthreaded)**

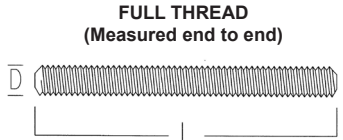

**FULL THREAD
(Measured first thread to first thread
per ASTM A193/A320)**

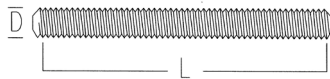

**Single End
Double End**

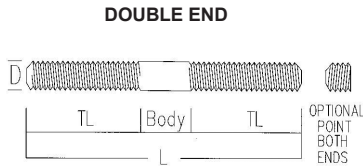

TAP END

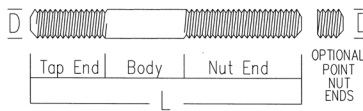

**Tap End
Radius End**

**Chisel Point
Reducing**

**CHISEL POINT
45° POINT**

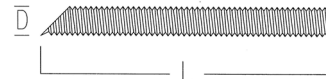

REDUCING

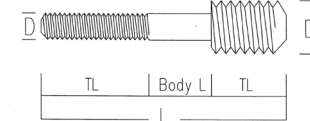

Diameters: No. 2 to 4" • Lengths: As Specified • Fits: 1A, 2A, 3A, 5 CSF, 5 ONF, and 5 HF

Order your Product Type with Diameter, Thread Pitch, Length(s) and Material

MANUFACTURING

NUTS

ASF STANDARD PRODUCT TYPES

**Hex
Heavy Hex**

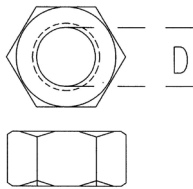

**Hex Jam
Heavy Hex Jam**

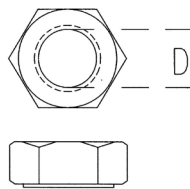

**Slotted
Heavy Slotted**

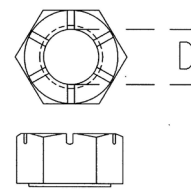

Square

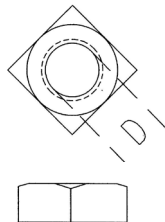

Castle

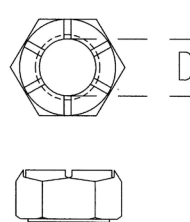

Flange

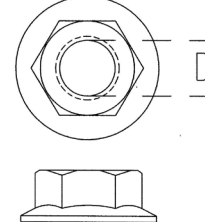

Order your Product Type with Diameter, Thread Pitch and Material

Quick Delivery



ALLOY & STAINLESS FASTENERS

MANUFACTURING

BOLTS

ASF STANDARD PRODUCT TYPES

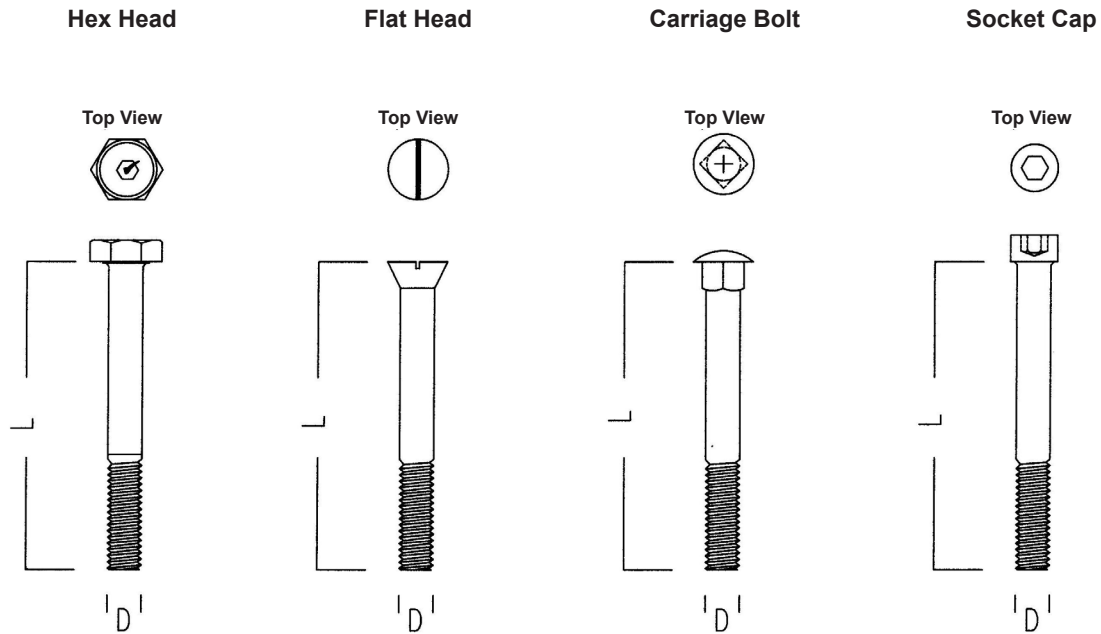

Order your Product Type with Diameter, Thread Pitch, Length and Material

LONG LENGTH BOLTS

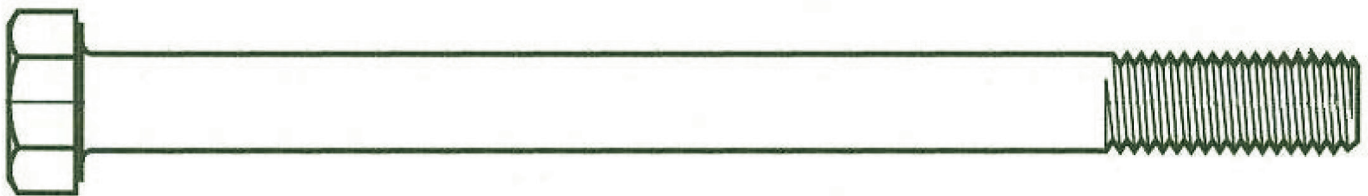

ASF manufactures long length bolts that range from 1/4" and larger in diameter and in lengths up to 40" long, in a variety of materials and in the customer's choice of standard head or custom designed head styles.



ALLOY & STAINLESS FASTENERS

COATINGS • PLATINGS • FINISHES

Zinc
Cadmium, ASTM B766
Xylan 1424, 1014, 1070, 1052
Xylar 2
Hot-Dip Galvanized
Phosphate
Zinc & Manganese
Fluoropolymer
Armoloy
Black Oxide
Sermagard

Silver
Gold
Nickel
Copper
Chrome
Electropolishing
Passivation
Anodine
Molybdenum Disulfide
O₂ Cleaning

and many more...

ASF meets Industry Leaders' Proprietary Specifications

Air Liquide

Galvanizing per A-GS-4-2-1 Rev B

Aker Solutions

C-156 & C-169

BAE Systems

Baker Hughes

BCS A401

BP

Cameron

Chevron

Aluminizing per EG-5012

Dresser Rand

Dupont

SP11C

Exxon

GP 29-02-13 &

RUSD-WPE-T2-LS-61100.3403

FMC Technologies

C81000, C81004 & C81007

GE Oil & Gas

Lockheed Martin

National Oilwell Varco

Oil States Industries

SV2D-00-014 & SV5D-00-025

Schlumberger

Vetco Gray

6.3.2, 6.3.1, 6.3.4, 6.3.16,
6.2.12, & 6.3.14

Well Dynamics

Wood Group

Quick Delivery



ALLOY & STAINLESS FASTENERS

MANUFACTURING MATERIALS

STAINLESS STEELS

303
 304
 304 STRAIN HARD
 304 ELC
 309
 310
 316
 316 STRAIN HARD
 316 ELC
 317 ELC
 321
 330
 347
 410
 410 HEAT TREATED
 416
 501 HEAT TREATED
 630
 * 17-4 PH
 904L
 ALLOY 20
 * A286
 * 254 SMO
 * AL-6XN
 * CARPENTER 20Cb-3
 * FERRALIUM 255
 * NITRONIC 50
 * NITRONIC 60

STAINLESS STEELS

ASTM A193 B5
 ASTM A193 B6
 ASTM A193 B8 CLASS 1
 ASTM A193 B8 CLASS 2
 ASTM A193 B8M CLASS 1
 ASTM A193 B8M CLASS 2
 ASTM A193 B8C
 ASTM A193 B8R
 ASTM A193 B8S
 ASTM A193 B8T
 ASTM A320 B8 CLASS 1
 ASTM A320 B8 CLASS 2
 ASTM A320 B8M CLASS 1
 ASTM A320 B8M CLASS 2
 ASTM A453 660A
 ASTM A453 660B
 ASTM A453 660D

DUPLEX

2205

SUPER DUPLEX

2507

* ZERON 100

TITANIUM

ASTM B348
 ASTM B381

NICKEL ALLOYS

* NICKEL 200
 * MONEL 400
 * MONEL K-500
 * INCONEL 600
 * INCONEL 601
 * INCONEL 625
 * INCONEL 718
 * INCONEL X-750
 * INCONEL 925
 * INCOLOY 800H
 * INCOLOY 825
 * HASTELLOY C-22
 * HASTELLOY C-276

COPPER ALLOYS

COPPER
 BRASS
 NAVAL BRASS
 SILICON BRONZE
 ALUMINUM BRONZE
 PHOSPHOR BRONZE
 CUPRO-NICKEL

ALLOY STEELS

4140
 4340
 ASTM A193 B7
 ASTM A193 B7M
 ASTM A193 B16
 ASTM A320 L7
 ASTM A320 L7M
 ASTM A320 L43
 ASTM A354 BD

ADDITIONAL MATERIAL GRADES

UPON REQUEST



*Registered Trademark

24 - 7 Service



www.GoASF.com

